

DETENTION HARDWARE

Heavy Duty Pulls and Handles

1004 – Flush pull – manganese bronze

- Institutional type – one piece casting
- Supplied with security fasteners

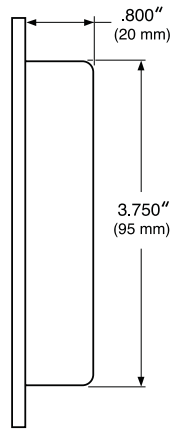

1004 EDP Number	Finish	Number of 1/4 – 20 x 1/2 security screws per piece	Quantity Per Box	Quantity Per Carton	Carton Weight	
					LBS.	(Kg)
32 – 2200	26D	4	5	30	45	(20.4)

2001 – Grip/pull handle– manganese bronze

- Heavy duty casting
- Supplied with security fasteners

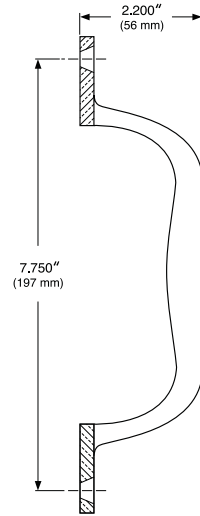

2001 EDP Number	Finish	Number of 3/8 – 16 x 5/8 security screws per piece	Quantity Per Box	Quantity Per Carton	Carton Weight	
					LBS.	(Kg)
32 – 2100	26D	2	5	32	37	(16.8)

2003 – Pull – Stainless steel

- 304 stainless steel solid bar
- Hex head cap screws with threadlocking nylon patch
- Concealed fastening requires a reinforcing plate and access plate with security fasteners for door edge to be supplied by door manufacturer

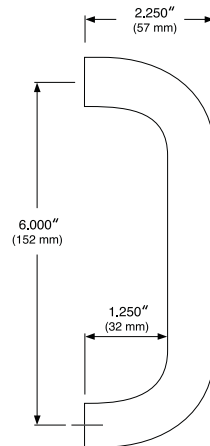

2003 EDP Number	Finish	Number of 3/8 – 16 x 1 Hex Head Cap Screws Per Piece	Quantity Per Box	Quantity Per Carton	Carton Weight	
					LBS.	(Kg)
32 – 2091	32D	2	1	15	30	(13.6)