

5 KNUCKLE FULL MORTISE HINGES

Standard Weight Concealed Bearing **LifeSpan**<sup>®</sup>

**CB179** – (ANSI A8112) Steel – polished and plated or phosphated and prime coated for painting

**CB191** – (ANSI A2112) Brass or bronze – polished and plated or painted

**CB191 (32)** – (ANSI A5112) Stainless steel – highly polished

**CB191 (32D)** – (ANSI A5112) Stainless steel – satin finish

- For medium weight doors of average frequency
- All hinges have template screw hole location for use on either wood or hollow metal doors and frames
- Concealed LifeSpan<sup>®</sup> bearing is maintenance free – no oil, no grease
- Pins in non-ferrous hinges are stainless steel
- Hole in bottom tip for easy pin removal
- Reversible flush tips and pins
- LifeSpan<sup>®</sup> limited lifetime warranty
- Hinges can be furnished as follows:
  - with raised barrel (RB)
  - with electric wires and/or switches (CE and/or CS)
  - with hospital tips (HT)
  - with decorative tips
  - with security studs
  - with non-removable pins (NRP)



Size Open		Gauge of Metal		Flat Head Screws Per Piece		Quantity Per Box	Quantity Per case	Case Weight			
Inches	(mm)	Inches	(mm)	Machine	Wood			Bronze		Steel	
							Lbs.	(Kg)	Lbs.	(Kg)	
3 1/2 x 3	(89 x 76)	.123	(3.1)	6 - 10-24 x 1/2	6 -10 x 1	3 EA.	90 EA.	58	(26)	54	(24)
3 1/2 x 3 1/2	(89 x 89)	.123	(3.1)	6 - 10-24 x 1/2	6 -10 x 1	3 EA.	90 EA.	65	(29)	59	(27)
4 x 3 1/2	(102 x 89)	.130	(3.3)	8 - 12-24 x 1/2	8 -12 x 1 1/4	3 EA.	48 EA.	43	(19)	39	(18)
4 x 4	(102 x 102)	.130	(3.3)	8 - 12-24 x 1/2	8 -12 x 1 1/4	3 EA.	48 EA.	45	(20)	42	(19)
4 1/2 x 4	(114 x 102)	.134	(3.4)	8 - 12-24 x 1/2	8 -12 x 1 1/4	3 EA.	48 EA.	55	(25)	52	(24)
4 1/2 x 4 1/2	(114 x 114)	.134	(3.4)	8 - 12-24 x 1/2	8 -12 x 1 1/4	3 EA.	48 EA.	59	(27)	55	(25)
5 x 4	(127 x 102)	.146	(3.7)	8 - 12-24 x 1/2	4 -12 x 1 1/4	3 EA.	30 EA.	41	(19)	39	(18)
5 x 4 1/2	(127 x 114)	.146	(3.7)	8 - 12-24 x 1/2	4 -12 x 1 1/4	3 EA.	30 EA.	45	(20)	43	(19)
5 x 5	(127 x 127)	.146	(3.7)	8 - 12-24 x 1/2	4 -12 x 1 1/4	3 EA.	30 EA.	50	(23)	46	(21)
*6 x 4 1/2	(152 x 114)	.160	(4.1)	10 -1/4-20 x 1/2	5 -14 x 1 1/2	3 EA.	24 EA.	43	(19)	36	(16)
*6 x 5	(152 x 127)	.160	(4.1)	10 -1/4-20 x 1/2	5 -14 x 1 1/2	3 EA.	24 EA.	47	(21)	40	(18)
*6 x 6	(152 x 152)	.160	(4.1)	10 -1/4-20 x 1/2	5 -14 x 1 1/2	3 EA.	24 EA.	67	(30)	61	(28)

\*Available in Steel only

Consult factory for other sizes not listed

**GENERAL HINGE INFORMATION**

**Special Situation Products**

- “CE” Concealed electric hinges conduct current regardless of door position to electric locks, exit devices, or hold open devices where tamper-proof hinge is required. Also to transmit signals from code readers on doors to remote computers for access control
- No electrical parts are exposed when hinge is installed
- Permanent fast pin
- Hinges should be installed in the center hinge location
- Not available as swing clear or raised barrel
- Hinges may be equipped with both concealed wires and concealed switches. When both are desired on the same hinge use prefix “CECS”
- Packed one per box with all machine screws and installation instructions
- When ordering specify class number, size, finish and number of wires  
Suffix -54 for 4 wires, 56 for 6 wires -66 for 6 wires (2@24AWG, 4@28AWG), 58 for 8 wires or 10 for 10 wires
- Should be used along with a junction box
- Can be furnished with hospital tips

**CECB179**  
**CECB168**  
**CECB191**  
**CECB199**  
5-Knuckle  
Concealed  
Bearings



**CEFBB179**  
**CEFBB168**  
**CEFBB191**  
**CEFBB199**  
5-Knuckle  
Exposed  
Bearings



**CECB1900R**  
**CECB1901R**  
**CECB1960R**  
**CECB1961R**  
3-Knuckle  
Concealed  
Bearings



Not  
Handed



Not  
Handed



Handed  
Specify  
RH or LH



**Electrical Ratings**

Suffix	# Wires	Wire Gage	Volts (AC or DC)	
			6, 12, 24	48
			Current	
-54	4	28AWG	1 amp/wire	5 milli-amp/wire
-56	6	28AWG	.7 amp/wire	5 milli-amp/wire
-58	8	28AWG	.5 amp/wire	5 milli-amp/wire
-10	10	28AWG	.4 amp/wire	5 milli-amp/wire
-66*	6	2@24AWG	2 amp/wire	5 milli-amp/wire
		4@28AWG	1 amp/wire	5 milli-amp/wire

Inrush 15A for .05 second/wire

“CE” hinges are listed by UL at these ratings

\* Not available in FBB168 and FBB199

**Class Number**

Class Number	Sizes Available	
CB179, FBB179, CB1900R	4 1/2" x 4"	(114mm x 102mm)
CB168, FBB168, CB1901R	4 1/2" x 4 1/2"	(114mm x 114mm)
CB191, FBB191, CB1960R	5" x 4"	(127mm x 102mm)
CB199, FBB199, CB1961R	5" x 4 1/2"	(127mm x 114mm)
	5" x 5"	(127mm x 127mm)
	6" x 4 1/2"	(152mm x 114mm)
	6" x 5"*	(152mm x 127mm)
	6" x 6"*	(152mm x 152mm)

\* Not available in CB191, FBB191, CB1900R and CB1960R

**JB2R – Junction Box**

- Note: Install in middle hinge location
- Can be shop welded or field installed — before frames are set
- Fits either 4 1/2" (114mm) or 5" (127mm) size hinges

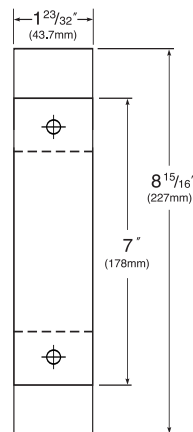
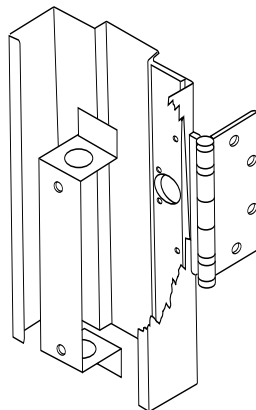

Junction Box  
Top View

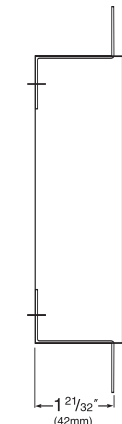

Right Side  
View

## GENERAL HINGE INFORMATION

### Special Situation Products

- “CS” (Concealed Switch) Allows opening monitoring, switch operates when door is either open or closed.  
Used to activate alarms, monitoring devices, or other security equipment when a tamper-proof hinge is required
- Single pole double throw switch
- Packed one per box with screws and installation instructions
- No electrical parts are exposed when hinge is installed
- Hinges should be installed in the center hinge location
- When ordering specify class number, size, finish and hand of door
- Hinges are available as follows:
  - with Non-Removable Pins (NRP)
  - with hospital tips (HT)

**CSCB179**  
**CSCB168**  
**CSCB191**  
**CSCB199**  
5-Knuckle  
Concealed  
Bearings



**CSFBB179**  
**CSFBB168**  
**CSFBB191**  
**CSFBB199**  
5-Knuckle  
Exposed  
Bearings



**CSCB1900R**  
**CSCB1901R**  
**CSCB1960R**  
**CSCB1961R**  
3-Knuckle  
Concealed  
Bearings



#### Electrical Ratings

Volts AC or DC	Current Rating	
	Resistive	Inductive
6	.30amp	.30amp
12	.25amp	.25amp
24	.20amp	.15amp
48	.15amp	.12amp

#### Class Number

Class Number	Sizes Available
CB179, FBB179, CB1900R	4 1/2" x 4" (114mm x 102mm)
CB168, FBB168, CB1901R	4 1/2" x 4 1/2" (114mm x 114mm)
CB191, FBB191, CB1960R	5" x 4" (127mm x 102mm)
CB199, FBB199, CB1961R	5" x 4 1/2" (127mm x 114mm)
	5" x 5" (127mm x 127mm)
	6" x 4 1/2" (152mm x 114mm)
	6" x 5" * (152mm x 127mm)
	6" x 6" * (152mm x 152mm)

\* Not available in CB191, FBB191 and CB1960

Hinges may be equipped with both concealed wires and concealed switch. When both are desired use prefix CECS. Specify hand.



5-Knuckle  
Concealed Bearings



5-Knuckle  
Ball Bearings



3-Knuckle  
Concealed Bearings